

Gripper

AF40-40

Character

- Suitable for inside diameter gripping (Bobbin) by wedge guide driving unit
- Excellent gripping force
- Possible to grip directly without the additional mounting of jaw
- Magnetic sensor is available for open-close sensing



Air chuck suitable for bobbin handling

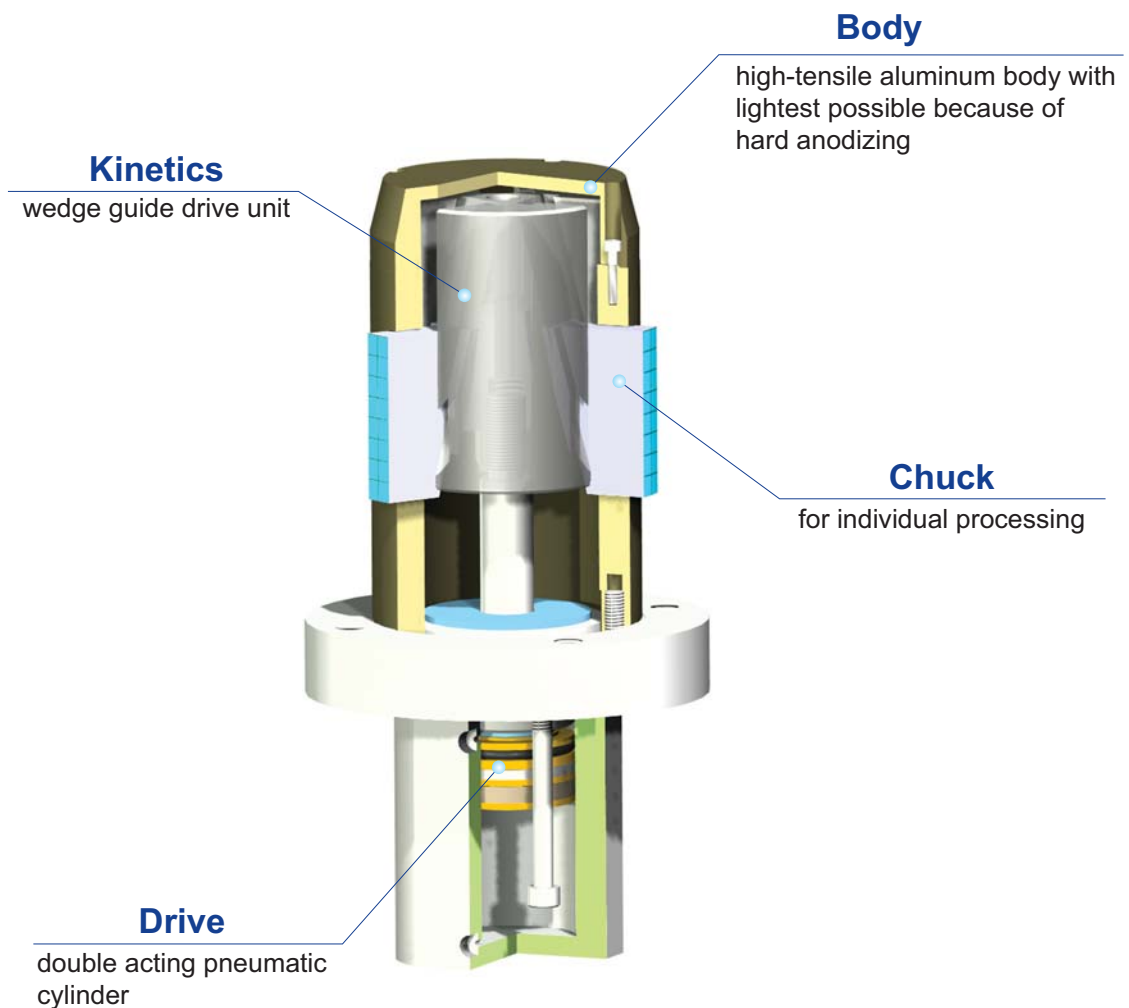

AF40

Exploded view

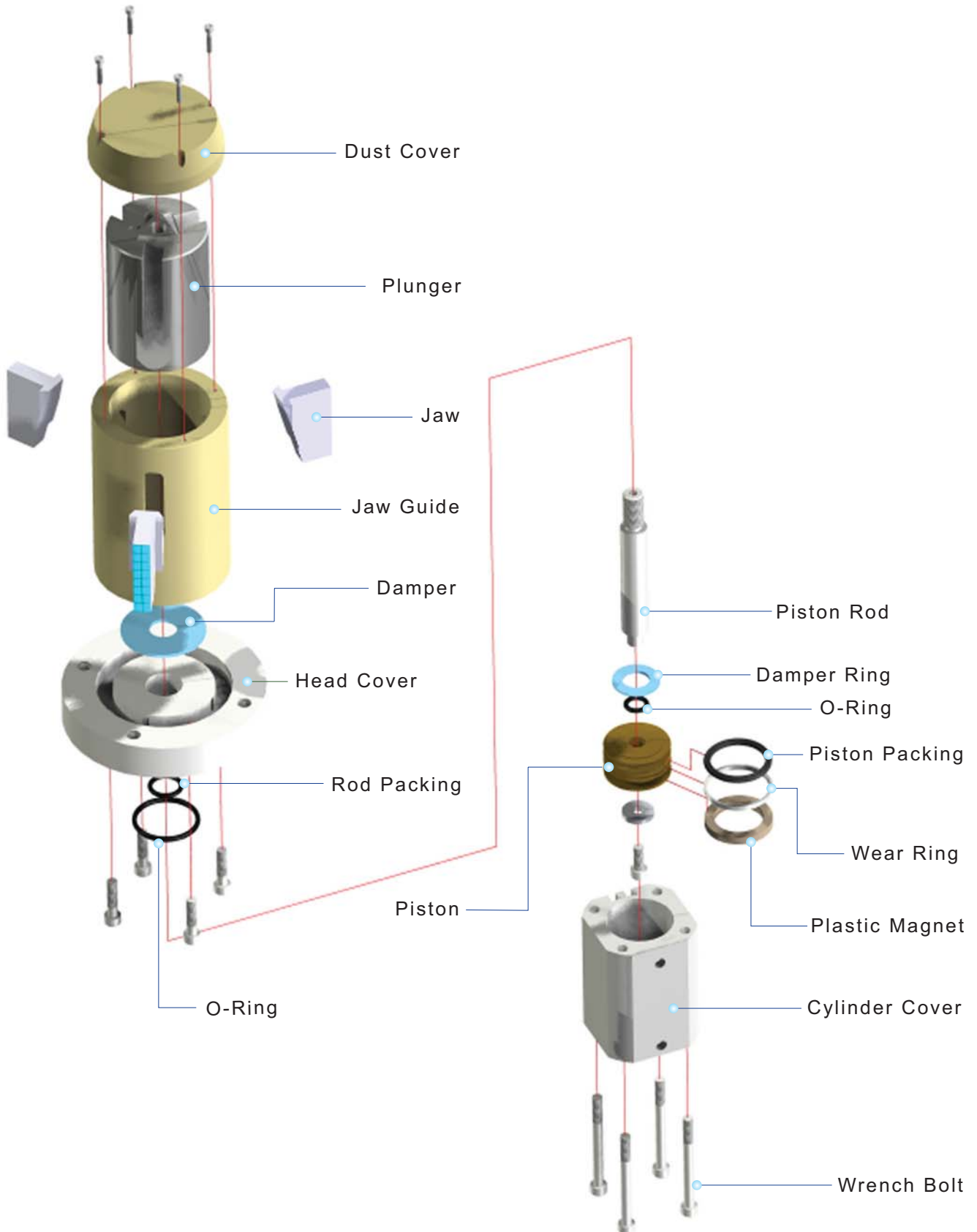

AF40

Ordering Code

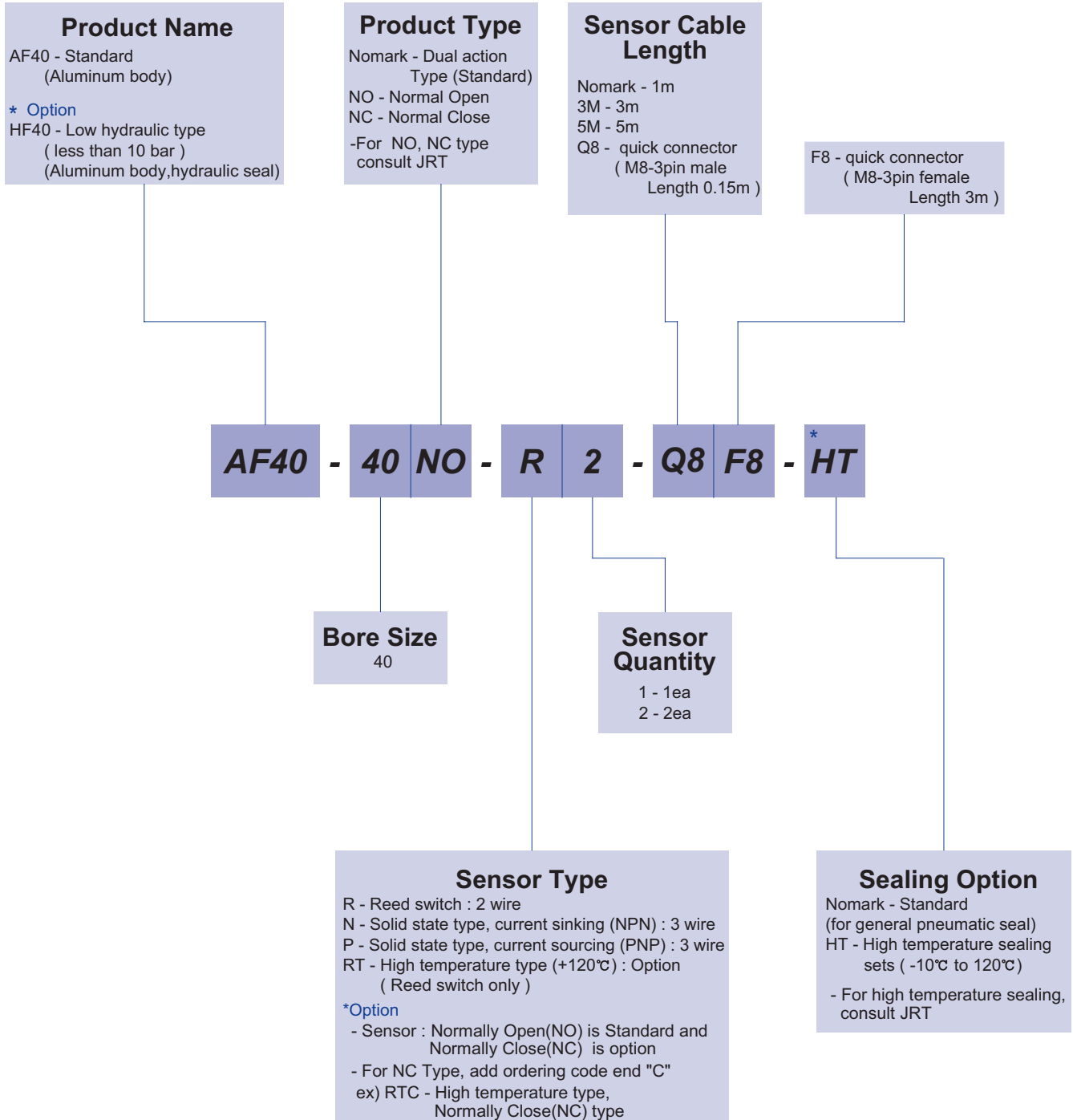

The delivery of * mark option is longer than a standard, So inquire of JRT

AF40

Specification

P=Air Pressure[bar] , L=Exertion length[mm]

Products Name	AF40-40	Unit
Stroke	22	mm
Weight	4.5	kg
Max. length of attach	100	mm
Fitting size	PF(G) 1/8	
Gripping force:Open	$367.88P/(1+0.005L)$	N
Gripping force:Close	$201.11P/(1+0.005L)$	
Air consumption per cycle	92.5	cm ³
Closing / Opening time	0.10 / 0.10	sec
* Repeat accuracy	0.01	mm
Max.cycle per minute	30	
Operating pressure	3~7	bar
Ambient temperature	-5 to 60	°C
Lubrication	Needless	

* After 100 consecutive strokes to end positions

Gripping Force per exertion length

Legend : ■ 7[bar] ■ 5[bar] ■ 3[bar]

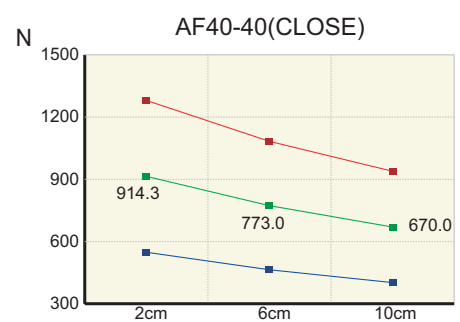
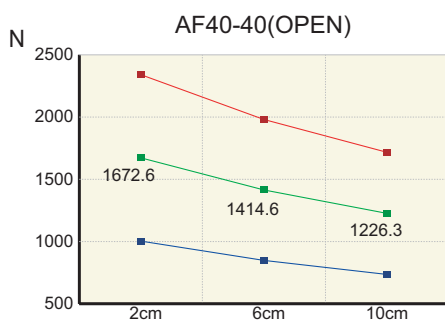

AF40

AF40

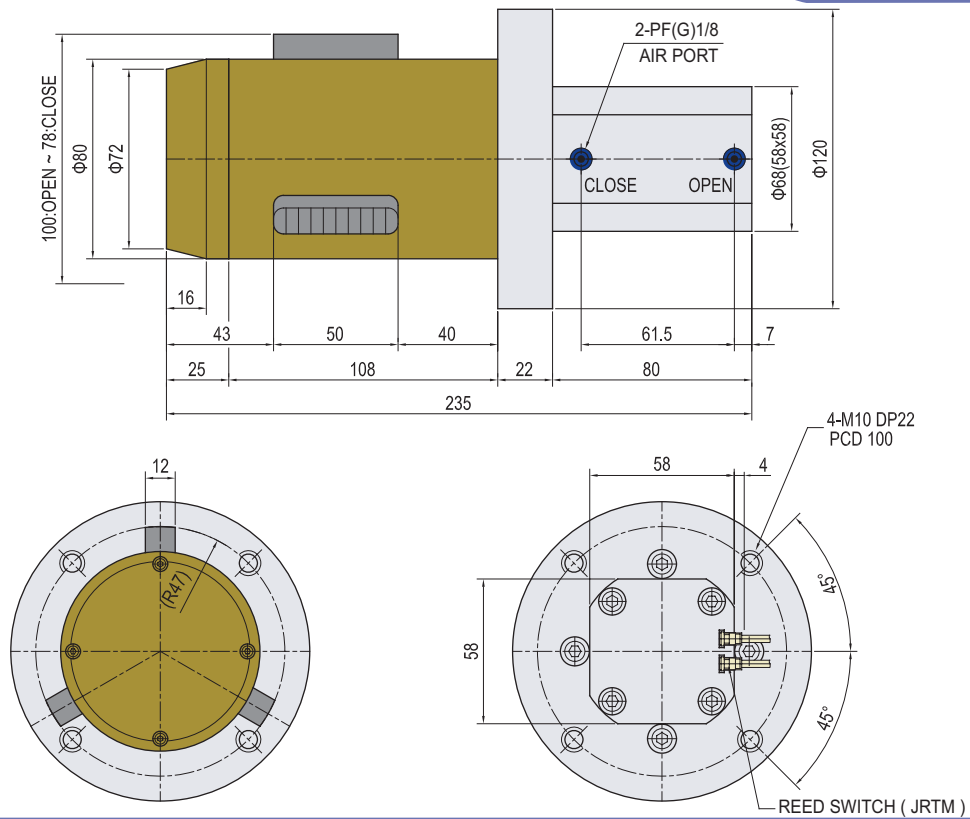

Note

Notes

A large grid of dashed lines for writing notes. The grid consists of 20 columns and 25 rows of squares, with rounded corners on the top and bottom edges. The lines are thin and grey, creating a clean and professional appearance.