

# Gripper

AF02-16,20,30,40,63

## Character

- Rack & pinion type
- High gripping forces by the structure of synchronized dual piston
- Magnetic sensor is available for open-close sensing

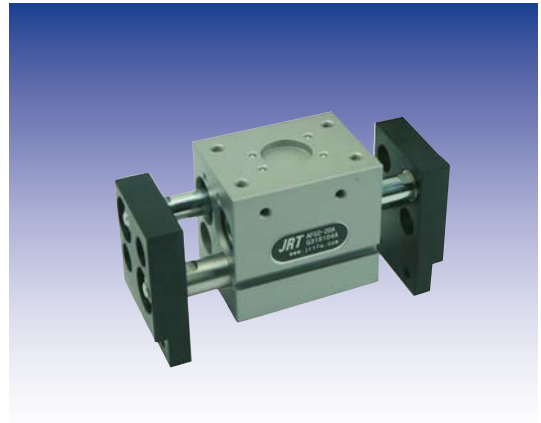

## Rack & pinion type

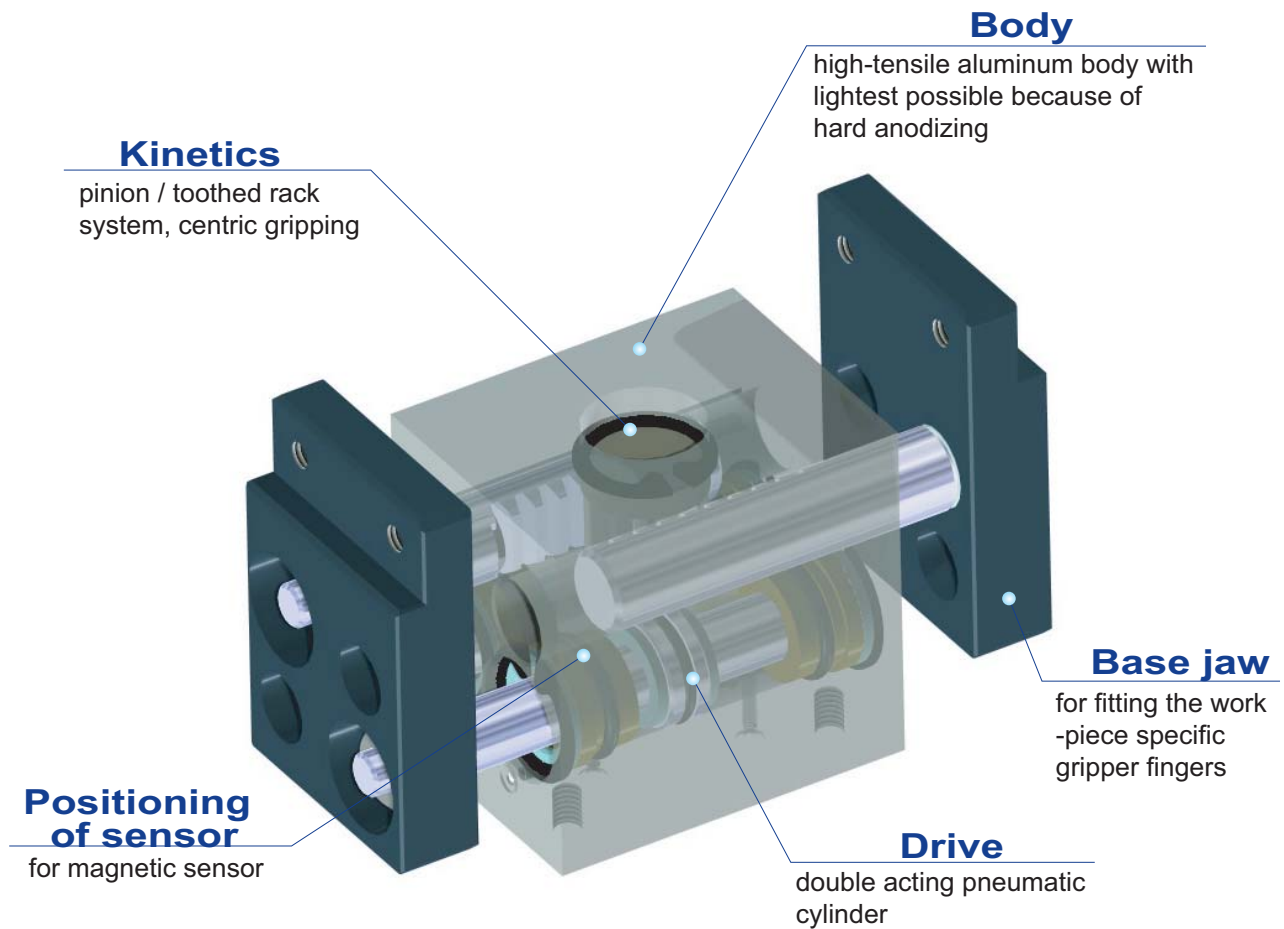

# AF02

## Exploded view

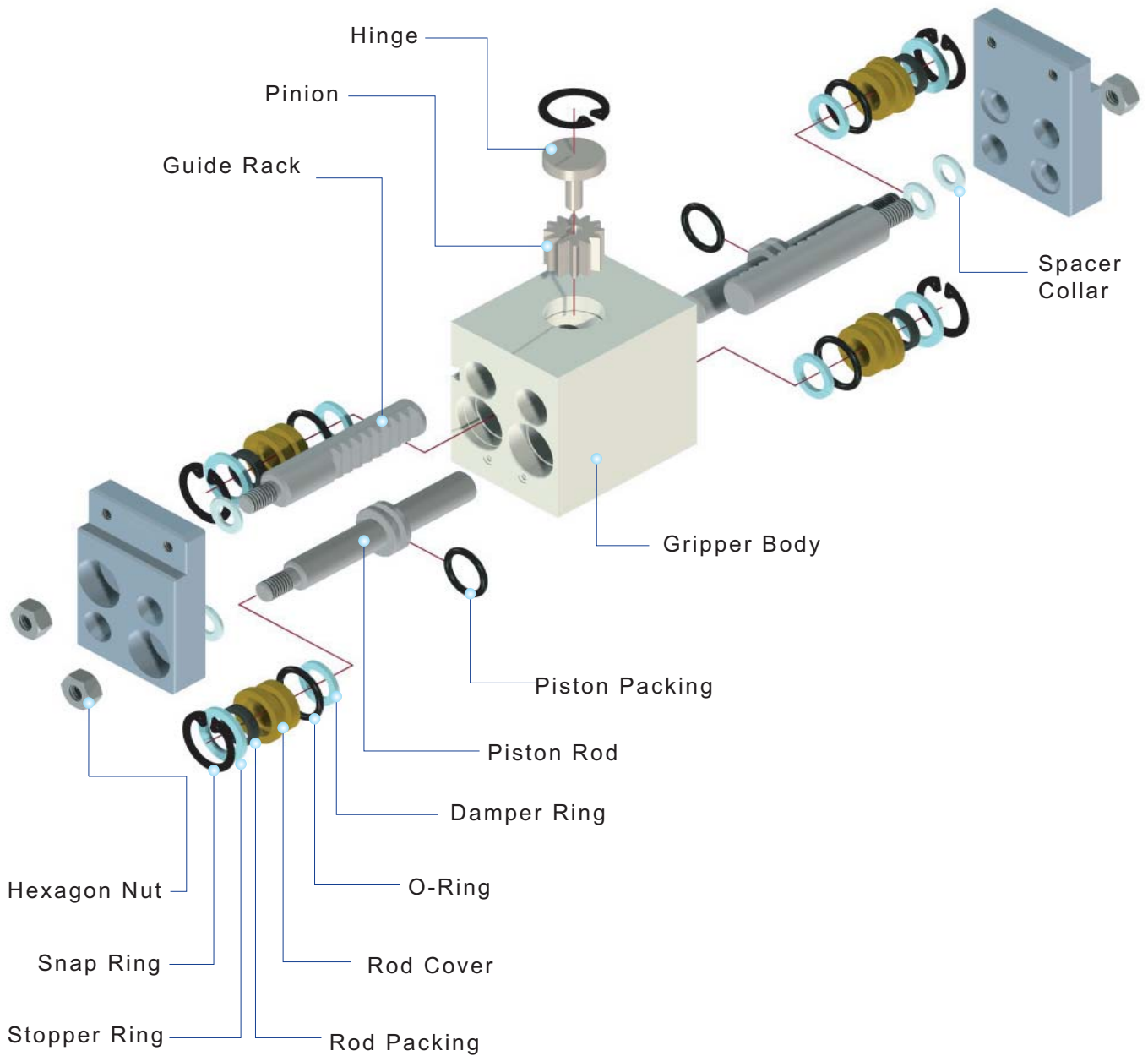

# AF02

## Ordering Code

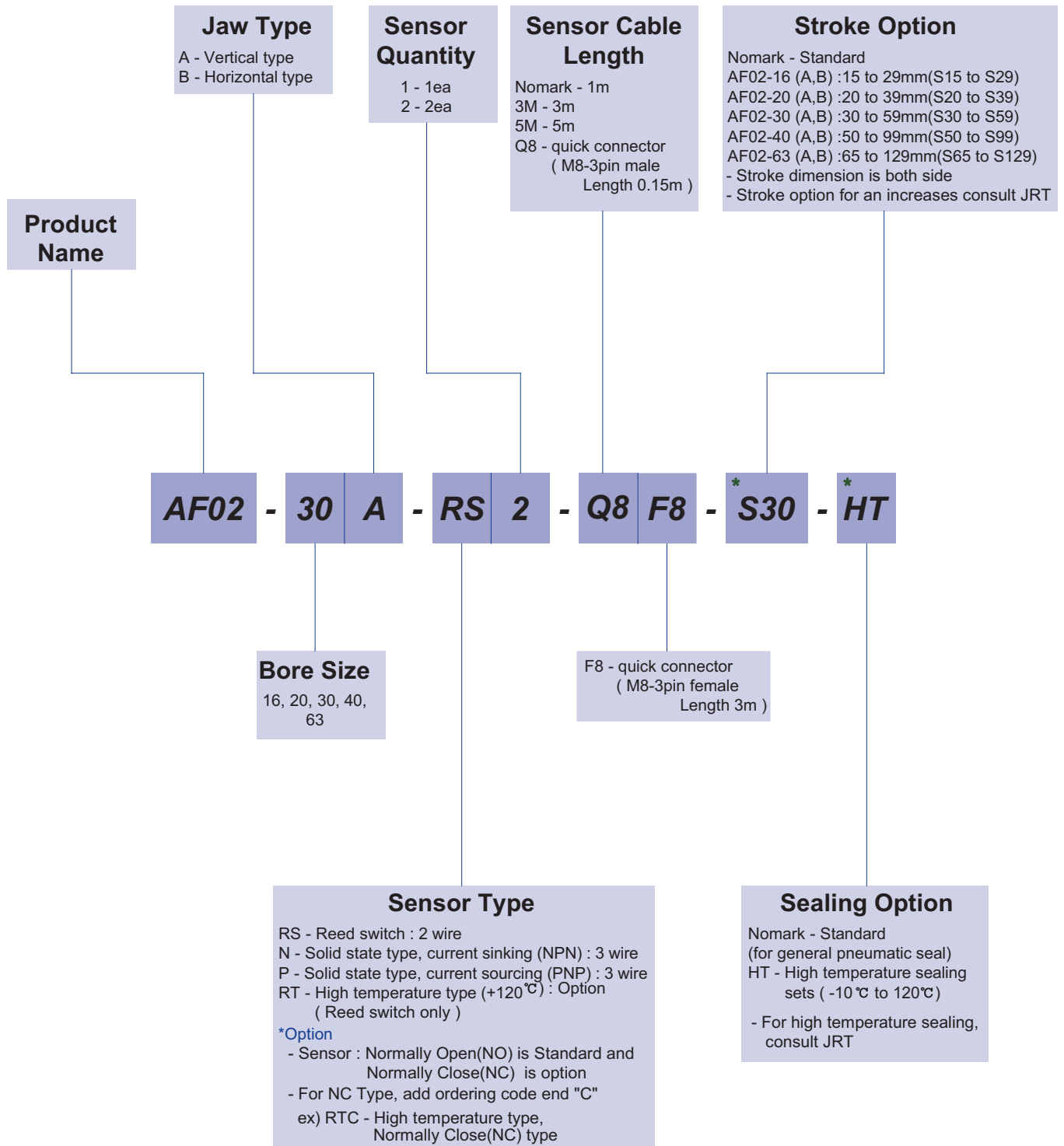

The delivery of \* mark option is longer than a standard, So inquire of JRT

# AF02

## Specification

P=Air Pressure[bar] , L=Exertion length[mm]

Products Name	AF02-16	AF02-20	AF02-30	AF02-40	AF02-63	Unit
Stroke	30	40	60	100	130	mm
Weight	0.55	1.05	2.88	6.2	18.2	kg
Max. length of attach	50	90	100	160	200	mm
Fitting size	M5	M5	M5	PF(G) 1/8	PF(G) 1/4	
Gripping force:Open	20.6P/(1+0.0075L)	20.6P/	49.05P/	148.13P/	296.26P/	N
Gripping force:Close	12.07P/(1+0.0075L)	(1+0.005L)	(1+0.0025L)	(1+0.002L)	(1+0.002L)	
Air consumption per cycle	9.7	11.0	60.7	188.5	626.7	cm <sup>3</sup>
Closing / Opening time	0.01 / 0.01	0.01 / 0.01	0.03 / 0.03	0.09 / 0.09	0.31 / 0.31	sec
* Repeat accuracy	0.01	0.01	0.01	0.01	0.01	mm
Max.cycle per minute	40	40	30	30	20	
Operating pressure	3~7					bar
Ambient temperature	-5 to 60					°C
Lubrication	Needless					

\* After 100 consecutive strokes to end positions

## Gripping Force per exertion length

Legend : ■ 7[bar] ■ 5[bar] ■ 3[bar]

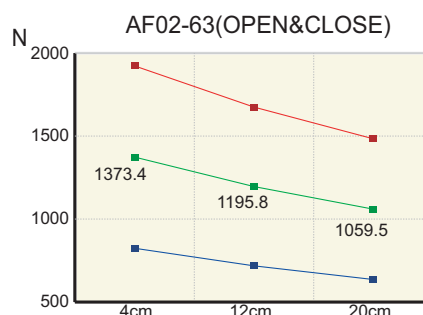
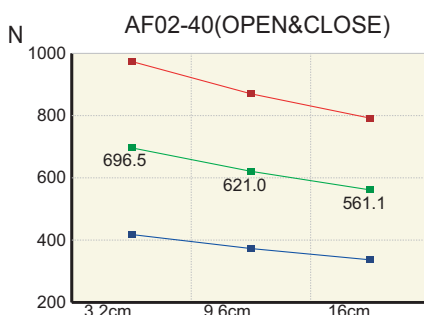
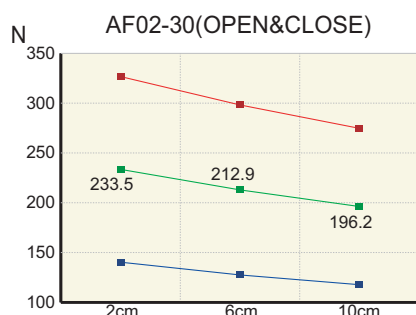
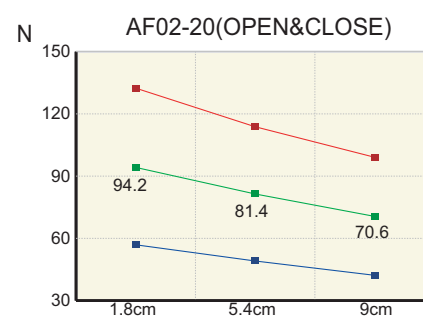
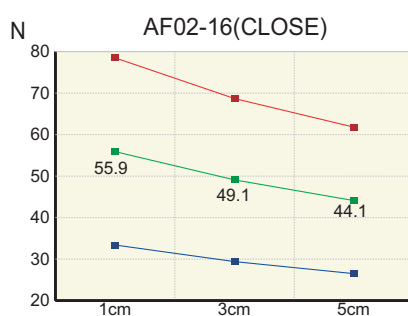
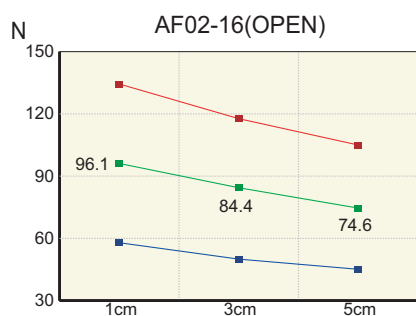



# AF02

## AF02-20A

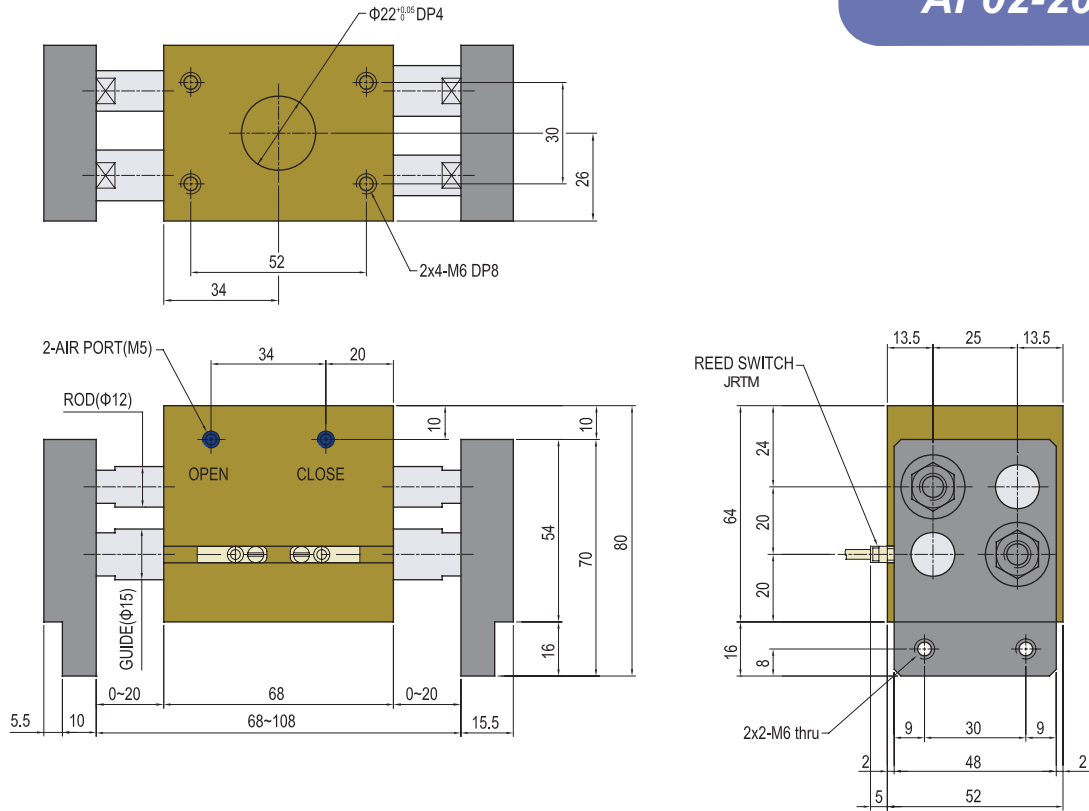

## AF02-20B

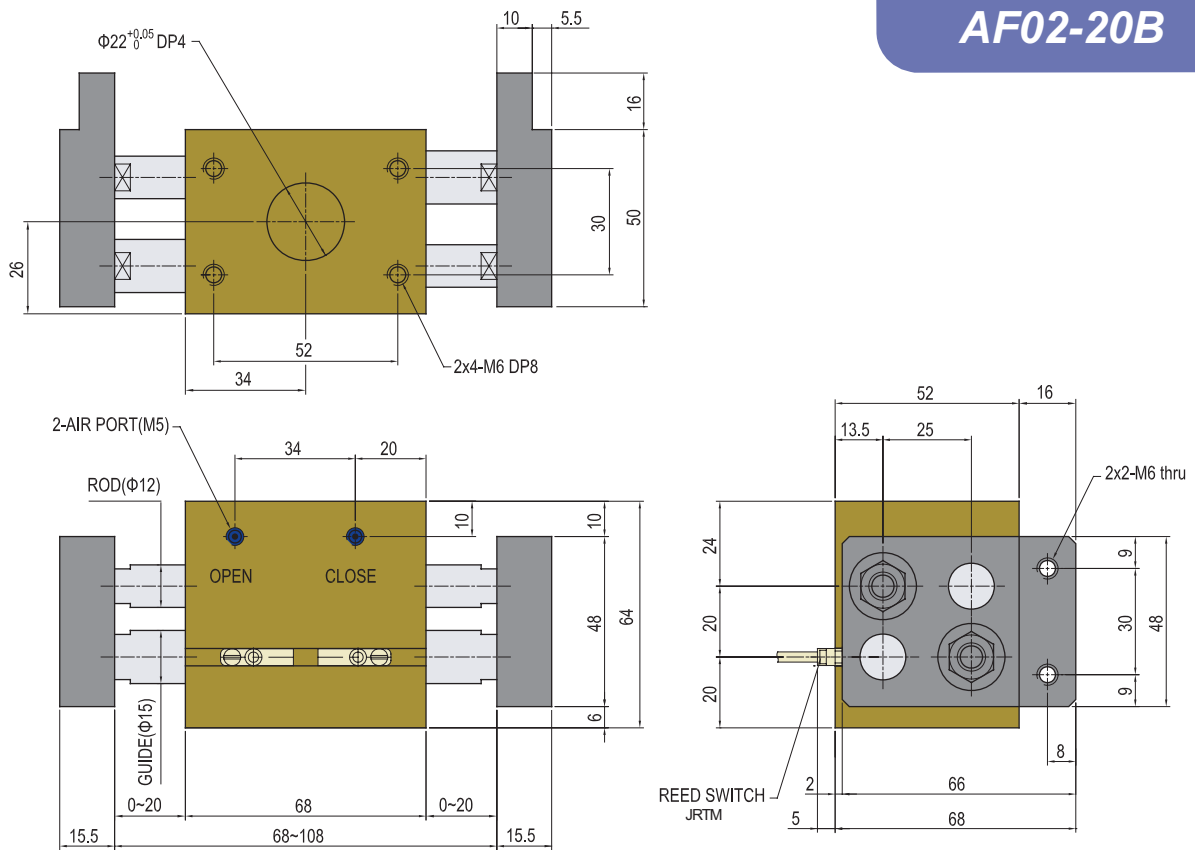

# AF02

## AF02-30A

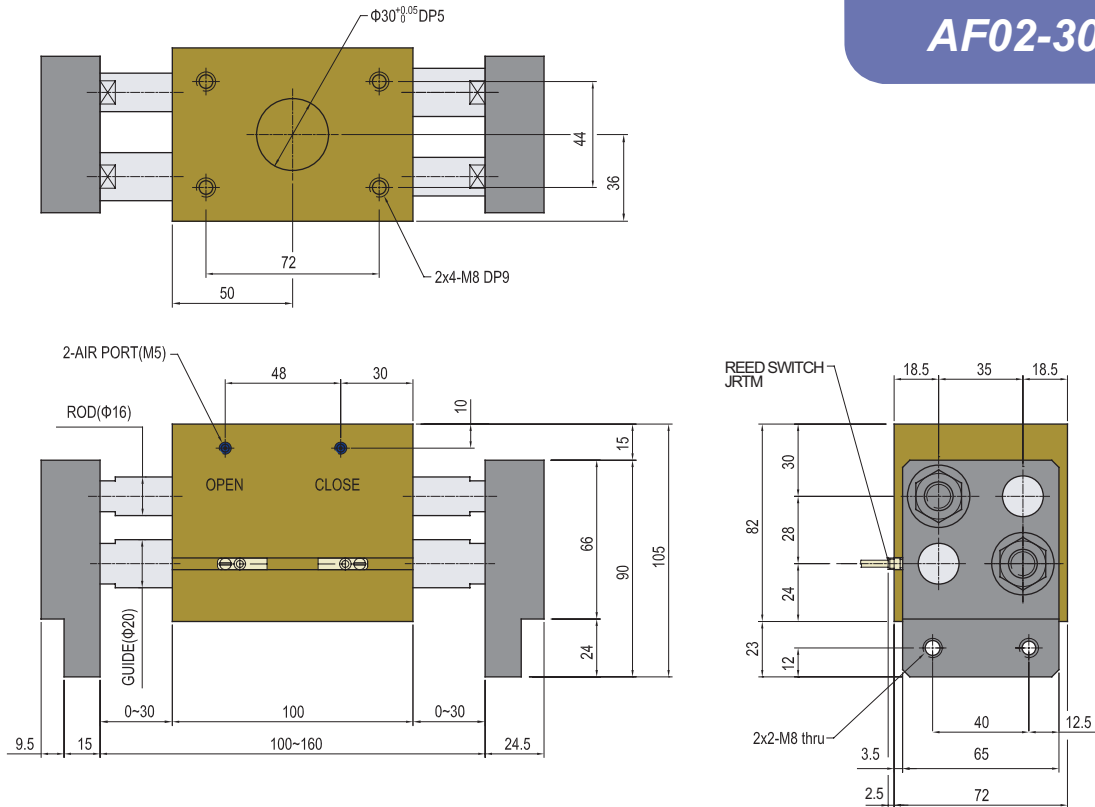

## AF02-30B

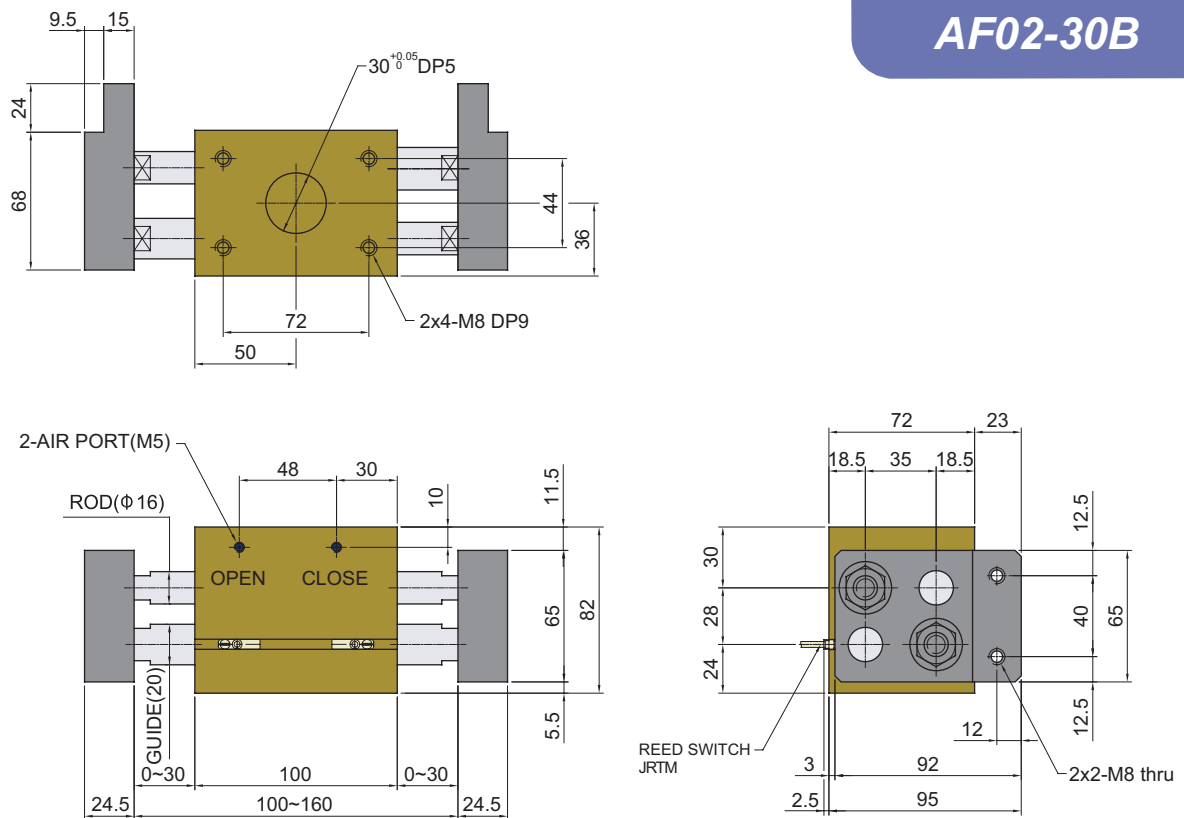





# AF02

## AF02-63A

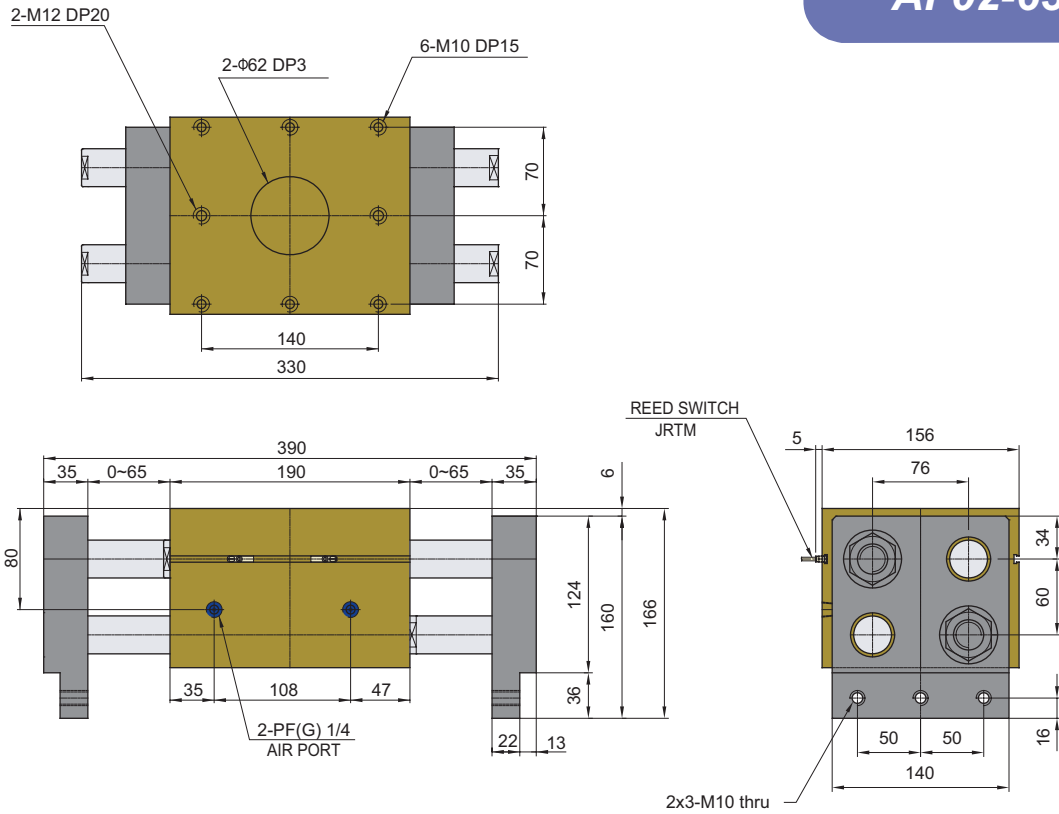

## AF02-63B

