



Small check valve with push-in joint

CHL Series

Compact and space saving line type for vacuum retention and low pressure use

- JIS symbol



Specifications

Descriptions	CHL-M54	CHL-H44	CHL-H66
Working fluid	Compressed air		
Max. working pressure MPa	1.0		
Min. working pressure MPa	0.03		
Cracking pressure MPa	0.03		
Working vacuum range kPa	-30 to -100		
Withstanding pressure MPa	1.5		
Fluid temperature range °C	0 to 60 (no freezing)		
Ambient temperature range °C	0 to 60 (no freezing)		
Port size	M5	φ 4	φ 6
Product weight g	8.9	10.8	16.6
Applicable tube outer diameter	φ 4	φ 4	φ 6
Flow ℓ/min (ANR)	170	180	440
Effective sectional area mm ²	2.6	2.8	6.8

Note: The flow is an atmospheric pressure conversion value at 0.5MPa.

How to order

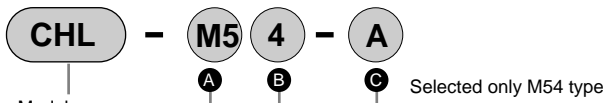

A Port size		B Tube outer diameter		C Free flow	
M5	M5	4	φ 4	A	M5 screw side input
H4	φ 4	4	φ 4	B	M5 screw side output
H6	φ 6	6	φ 6		

Note: Model no. must be selected according to above specifications.

© Free flow (M54 type only) explanation diagram

Free flow A (M5 screw side input)

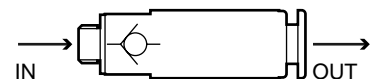

Free flow B (M5 screw side output)



Clean room specifications (catalog No. CB-033SA)

- Dust generation preventing structure for use in cleanrooms

CHL- - **P7***

Internal structure and part list

● CHL-M54

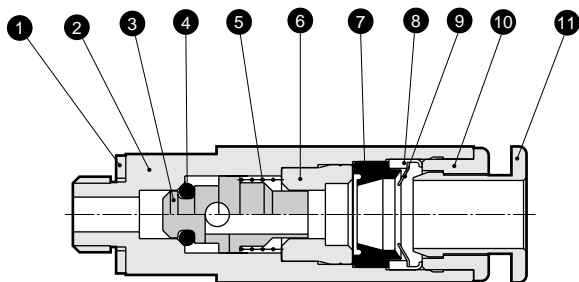

● CHL-H44, H66

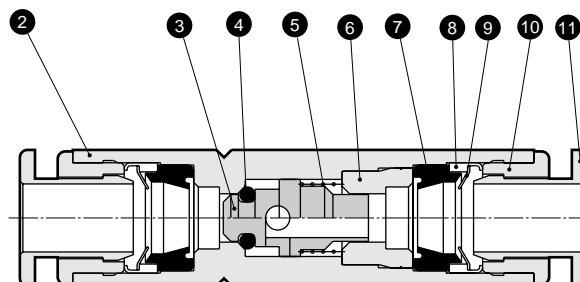

No.	Parts name	Material	No.	Parts name	Material
1	Gasket	Nitrile rubber, steel	6	Valve seat	Aluminum
2	Body	Brass (electroless nickeling)	7	Packing seal	Nitrile rubber
3	Valving element	Aluminum	8	Chuck holder	Brass (electroless nickeling)
4	O ring	Nitrile rubber	9	Chuck	Stainless steel
5	Spring	Stainless steel	10	Outer ring	Brass (electroless nickeling)
			11	Push ring	PBT

Dimensions



● CHL-M54*

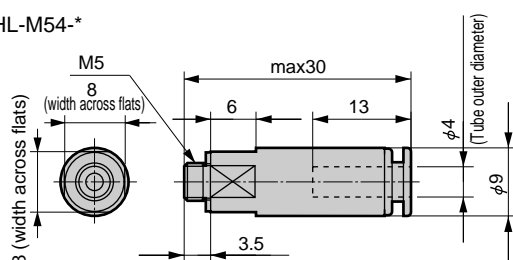

● CHL-H44

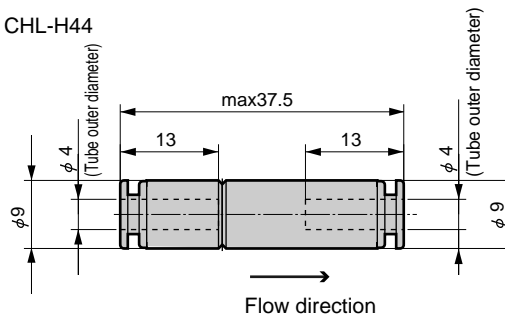

● CHL-H66

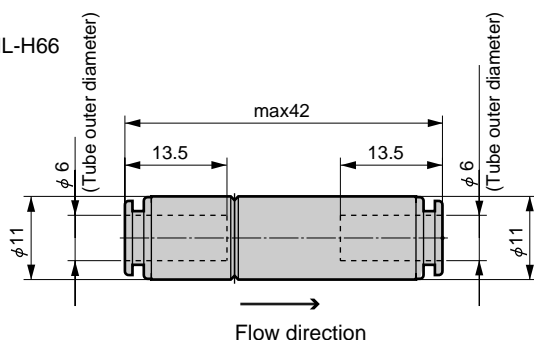

Refrigerating type dryer
Desiccant type dryer
High polymer membrane dryer
Air filter
Auto. drain / others
F.R.L. (Module unit)
F.R.L. (Separate)
Compact F.R.
Precise regulator
F.R.L. (Related products)
Clean F.R.
Electro pneumatic regulator
Air booster
Speed control valve
Silencer
Check valve / others
Joint / tube
Vacuum filter
Vacuum regulator
Suction plate
Magnetic spring buffer
Mechanical pressure SW
Electronic pressure SW
Contact / close contact conf. SW
Air sensor
Pressure SW for coolant
Small flow sensor
Small flow controller
Flow sensor for air
Flow sensor for water
Total air system
Total air system (Gamma)

Ending

Small check valve with push-in joint
Auxiliary valve