

## 16.216SJ

Galvaniseret snaplås. 67 x 48 mm.  
Galvanized fastener. 67 x 48 mm.

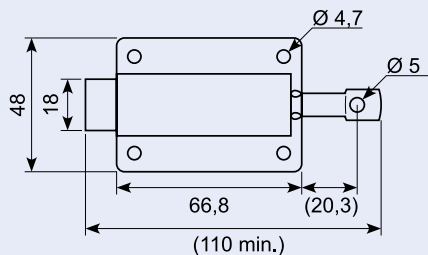

## 16.209

Galvaniseret skydelås. Rustfri bøjle med nylontunge. 40 x 70 mm plade med side pind.

Galvanized sliding latch. 40 x 70 mm plate with side pin.

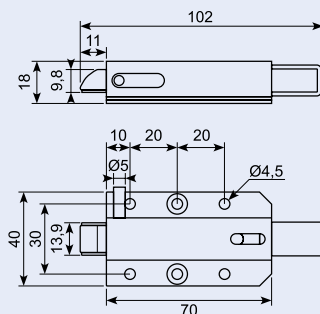

## 16.207

Galvaniseret skydelås. rustfri bøjle med nylontunge. 40x70 mm plade.

Galvanized sliding latch. 40 x 70 mm plate.

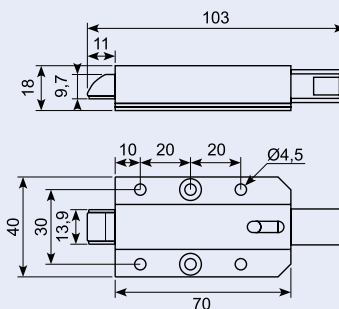

## 16.213J

Galvaniseret snaplås. Støbt massiv næse.

Galvanized latch. Cast massive nose.

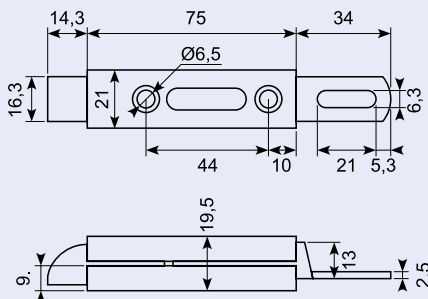
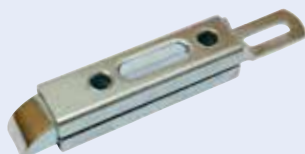

## 16.203J

Galvaniseret snaplås med krog.

Galvanized latch with hook.

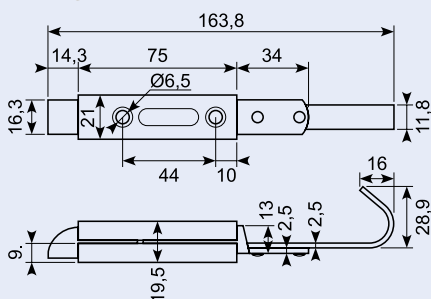
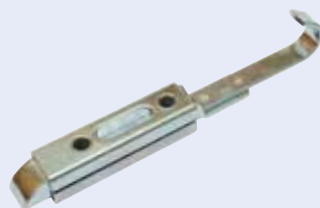

## 16.203SS

Snarlås Rustfri med krog. Tractive force 21N. Lidt blødere fjeder end 16.203J.

Stainless latch with hook. Tractive force 21N. Spring a little softer than 16.203J.

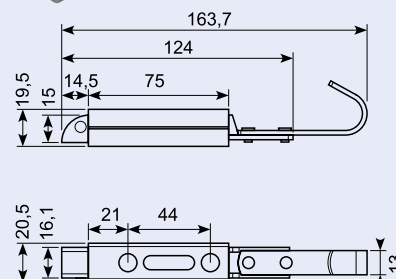

## 16.204

Galvaniseret skydelås.

Galvanized latch.

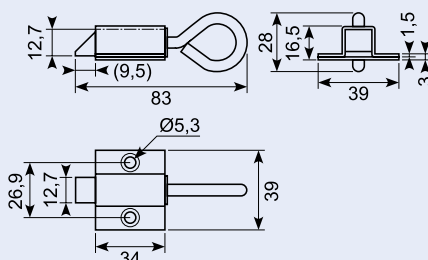
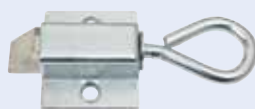

## 16.214

Snarlås, sort kunststof.

Moulded slam latch, black synthetic material.

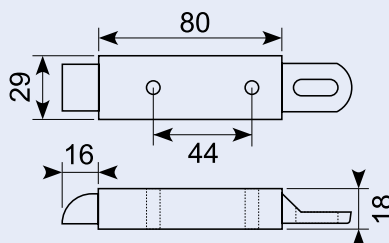
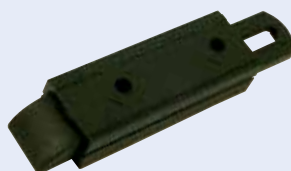

## 16.216S

Snarlås til 16.216MR/MRJX. "Nose down". Quick fit pull.

End latch for 16.216MR/MRJX. "Nose-down". Quick-fit pull.

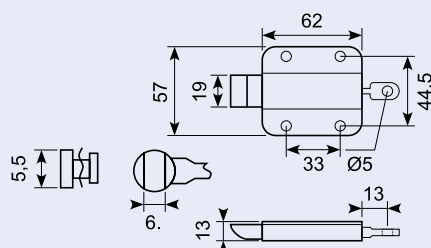
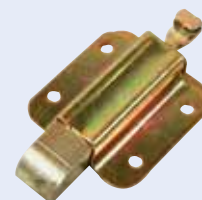

## 16.205X

**Snaplås i galvaniseret stål med omvendt gæk.**

Top-knob latch, nose-up mild steel.

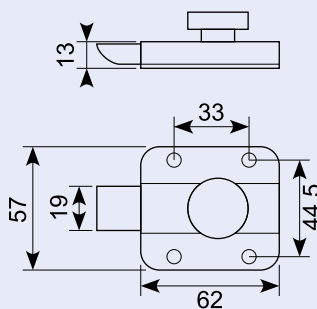
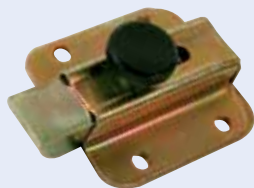

## 16.205

**Snaplås, galvaniseret stål med knop.**

Top-knob latch, nose-down. Mild steel.

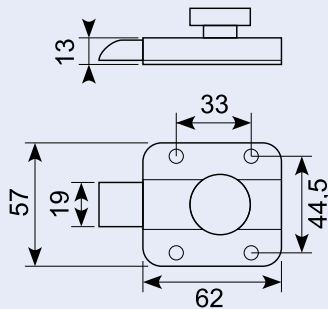
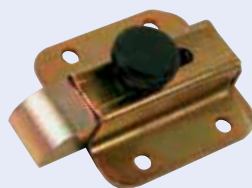

## 16.205R

**Snaplås, rustfrit stål med knop.**

Top-knob latch, nose-down SS.

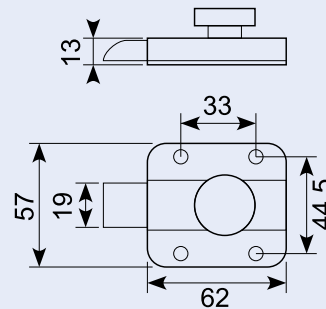
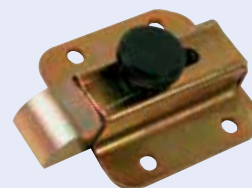

## 16.179

**Hagelås - venstre. Galvaniseret stål, til 8 mm stift**

Flush fitting lock - LH. Zink-plated, for 8 mm pin. Flush fitting lock left.

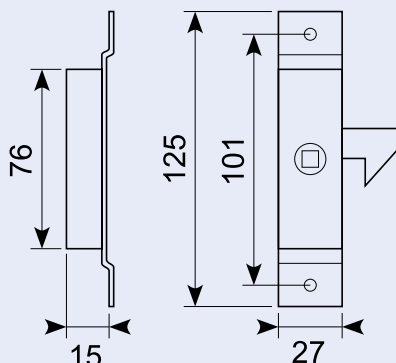

## 16.180

**Hagelås - højre. Galvaniseret stål, til 8 mm stift.**

Flush fitting lock - RH. Zink-plated, for 8 mm pin. Flush fitting lock right.

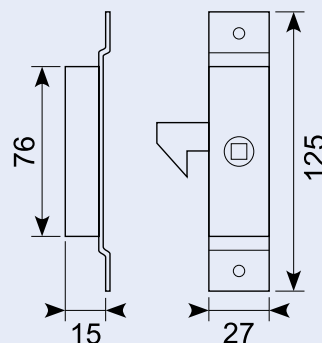

## 16.101J

**Dørlås 7mm FK. 4 - 8 micron. Se også 16.101JSS.**

Door lock. 7 mm FK. 4 - 8 micron. Also see 16.101JSS.

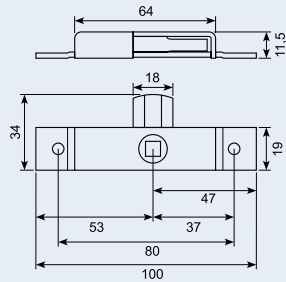
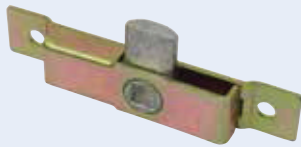

## 16.101JSS

**Dørlås. 7 mm FK. Rustfri SS304 + zink cam.**

Door lock. 7 mm FK. Stainless SS304 + zinc cam.

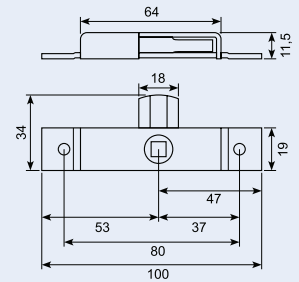

## 16.100R

**Tungelås uden sikring. Rustfri stål, til 8 mm stift.**

Stainless steel, for 8 mm T-key

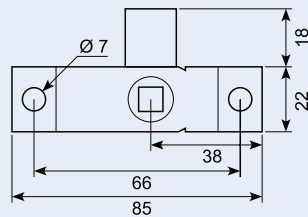

## 16.100X

**Tungelås uden sikring. Galvaniseret stål med ståltunge, til 8 mm stift.**

With steel bolt, for 8 mm T-key.

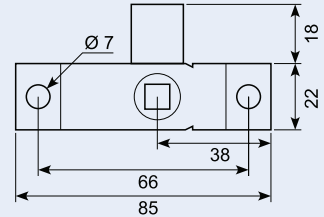

## 16.102

**Tungelås uden sikring. Galvaniseret jern til 8 mm stift.**

Latch lock without safety device. Zinc-plated steel, for 8 mm pin.

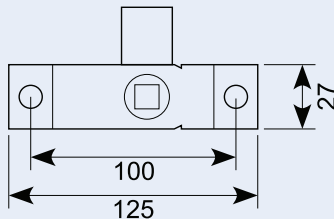

## 16.103

**Tungelås uden sikring - venstre. Zink-plated stål, til 8 mm stift.**

Handed budget latch - LH. Zinc-plated, for 8 mm T-key.

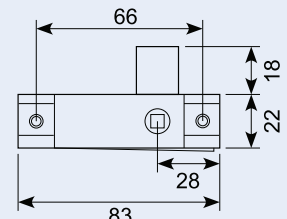
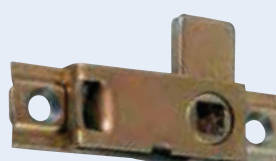

## 16.104

**Tungelås uden sikring - højre. Galvaniseret stål, til 8 mm. stift.**

Handed budget latch - RH. Zinc-plated, for 8 mm T-key.

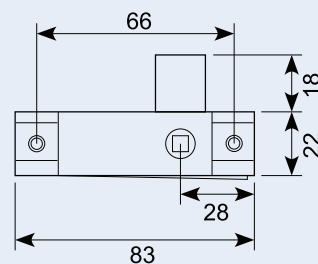

## 50.064110

**Dørlås, galvaniseret. 27 x 125 mm. Hulafstand: 102 mm**

Door lock.

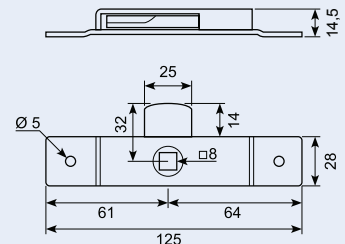
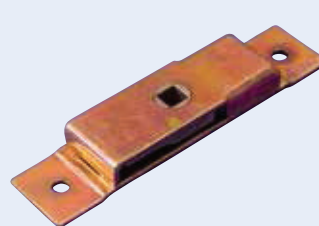

## 50.064120

**Dørlås, galvaniseret og aluminium tunge.**

**22 x 115 mm. Hulafstand: 94 mm**

Door lock.

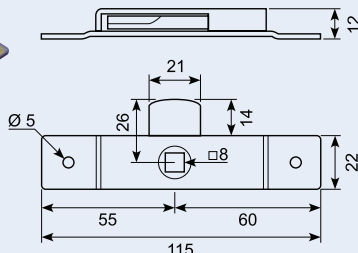
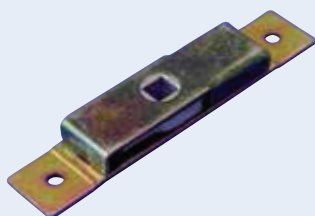

## 50.064130

**Dørlås, galvaniseret. 19 x 105 mm. Hulafstand: 86 mm**

Door lock.

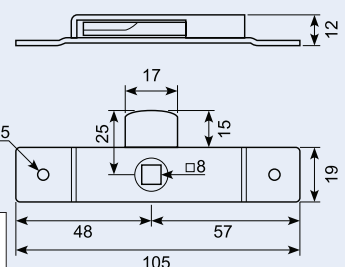
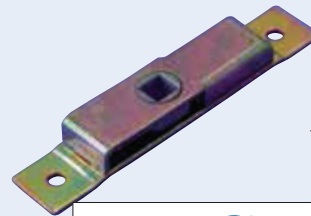

**BIBUS**  
SUPPORTING YOUR SUCCESS

BIBUS SK, s.r.o.  
Tmavská 31, SK-94 901 Nitra

Tel.: 0371 7777 911 Email: sale@bibus.sk  
Fax.: 0371 7777 999 http://www.bibus.sk

Godt køb / best buy