

# Data Sheet

## piCOBOT® Universal Robots



- ▶ Mechanical and electrical interfaces. Custom made for Universal Robots (UR) collaborative robots (UR3, UR5 and UR10 if not exceeding 7kg).
- ▶ Integrated safety related functions.
- ▶ Flexible setting options to perfectly match application needs.
- ▶ Vacuum ejector based on patented COAX® technology with integrated controls.
- ▶ Optimized design for high reliability.
- ▶ Valves with adaptive PWM (Pulse Width Modulation) to reduce heat generation and further improve reliability.
- ▶ Extra valve protection (Automatic Condition Monitoring, ACM, function).
- ▶ Light weight and low build height.
- ▶ UR software capabilities (URCaps) for quick and easy installation/implementation and programming, compatible with E-series and CB-series.
- ▶ Patented Intelligent Blow-off (IBO) automatically activates and stops the blow-off when vacuum is removed from system and optimizes the usage of blow-off air.
- ▶ Integrated automatic air/energy-saving function (ES) with adjustable hysteresis that will further reduce energy usage (up to 90–95%).
- ▶ Activate and optionally sets itself automatically (Automatic Level Determination, ALD, function).

## TECHNICAL DATA

Description	Unit	Value
<b>Installation</b>		
Total weight (without suction cups)	oz	33.4
piCOBOT® weight	oz	18
Adjustable gripper weight	oz	7.4
Max handled weight	oz	246.9
Material	-	PA, NBR, SS, Al, FPM, CuZn, Cu, PU
Supply voltage	VDC	24 ± 10%
Electrical connection	-	Connector M8, 8-pin female
Typical current consumption	mA	200
In rush current	mA	800
Valve shift peak current	mA	425
Valve shift peak current time	ms	<32
Feed pressure, max.	psi	101.5
Connection, compressed air	-	ø6 push-in angle connector
Connection, vacuum	-	G1/4" female
<b>Environmental properties</b>		
IP classification	-	IP54
Temperature range	F	32-104
Humidity	%RH	35-85
Vibration resistant at 2g xyz	Hz	8-200
Noise level range*	dBA	52-63
<b>Operations</b>		
Pressure drop	psi	0.018
Blow-off flow at 73 psi and no counter pressure	scfm	0.583
Blow-off flow at 73 psi and 14.5 psi counter pressure	scfm	0.19
Hysteresis	-	Adjustable
Function, Vacuum/Blow-Off	-	NC vacuum + NC Blow-Off
Display	-	OLED and gyro display
<b>Electrical input/output</b>		
Electrical input/output	VDC	24, UR specific
Analog output	V	1-5
Accuracy of F.S. (Full Scale) analog output	-	±3%
Manual override , electrically activated	-	Yes, non-locking push style
Signal range (digital output)	inHg	-29.92 – 41.34
Response time valve	ms	10 ± 2
Valve shift peak current	mA	425
Valve shift peak current time	ms	<32
Switch output S1/S2, max	mA	2x40 simultaneously or 1x80 one at a time
In rush current	mA	800

\*Higher noise level = free running vacuum (cups open)

## VACUUM FLOW

Feed pressure Pump nozzle psi	Air consumption scfm	Vacuum flow (scfm) at different vacuum levels (-inHg)										Max vacuum -inHg
		0	10	20	30	40	50	60	70	80		
66.7 / 58.0	0.97	1.36	1.18	0.98	0.72	0.42	0.30	0.16	0.08	0.02	24.8	

## EVACUATION TIME

Feed pressure Pump nozzle psi	Air consumption scfm	Evacuation time (s/cf) to reach different vacuum levels (-inHg)								Max vacuum -inHg
		3	6	9	12	15	18	21	24	
66.7 / 58.0	0.97	0.358	0.782	1.341	2.195	3.600	5.568	8.696	16.03	24.8

## DIMENSIONS

Description	Unit	Value
A	mm [in]	74.0 [2.91]
B	-	M8 8-pin female
C	mm	Ø6

Pos	Description
1	Compressed air
2	Vacuum
3	Exhaust

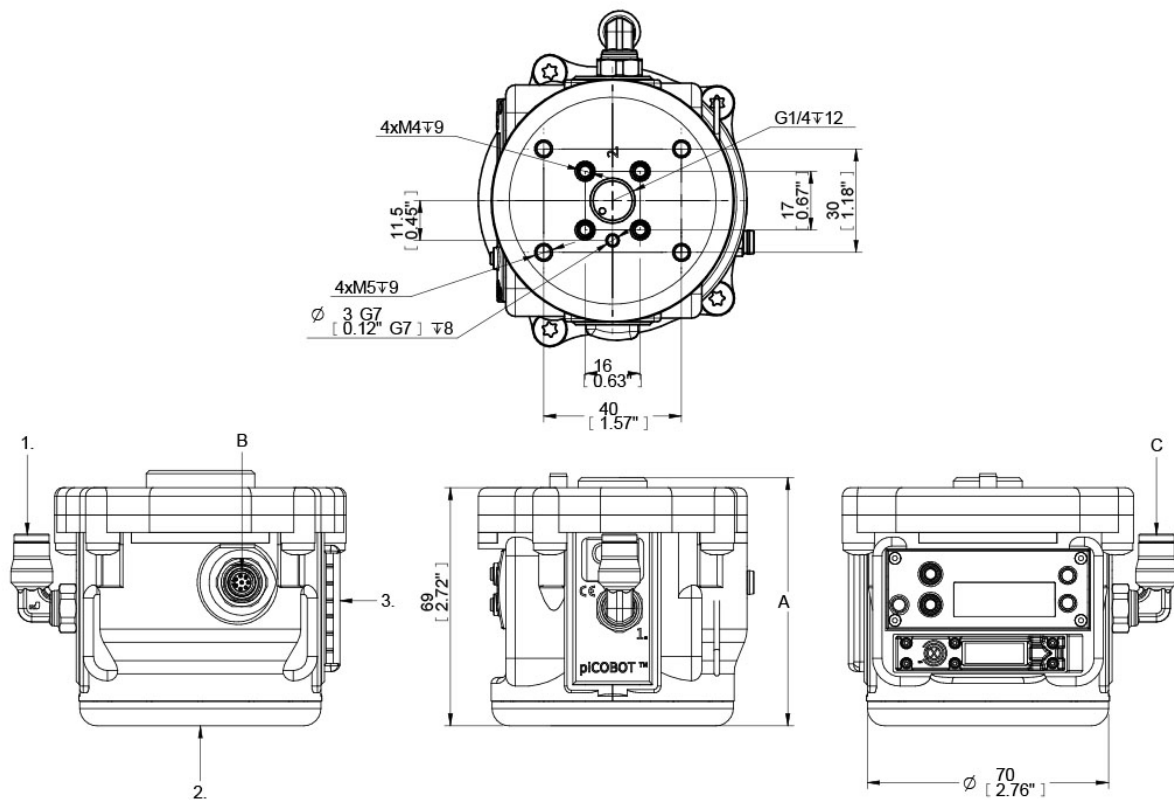

## Adapterplate ISO 9409-1-50 – 4 – M6

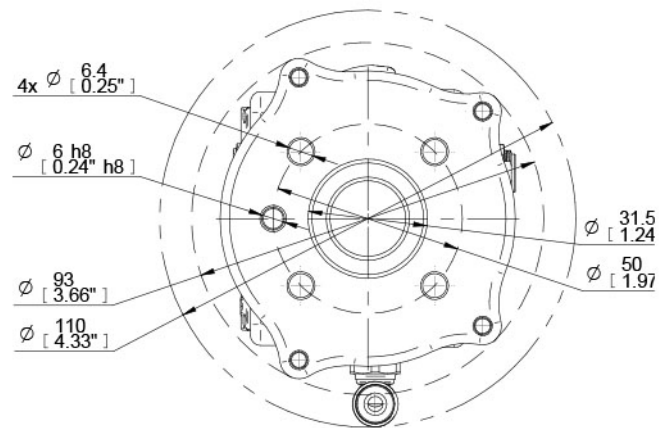

## GRIPPER



### FEATURES GRIPPER

- ▶ Flexible and adaptable to perfectly match application needs.
- ▶ Optimized design for high reliability and fast cycle times.
- ▶ Re-configurable within 2 minutes.
- ▶ Integrated piSAVE® sense technology allowing for single and/or double picking.
- ▶ Flexible and stepless adjustability in suction cup distance, 97-142mm.
- ▶ Stepless angle adjustability of individual suction cups,  $\pm 15^\circ$ . Allows for maximum adaption to object surface variations.
- ▶ Push-pin can be mounted on the adjustable gripper suitable for pressing buttons or reorient objects.

### TECHNICAL DATA GRIPPER

Description	Unit	Value
Material	-	PA, AL, SS, PU
Temperature range	F	0-50
Gripper weight	oz	244
Max payload	oz	7,000
Internal volume	in <sup>3</sup>	0.976
Thread for suction cup	-	G1/4"
Adjustable angle for cups	-	$\pm 15^\circ$

## DIMENSIONS GRIPPER

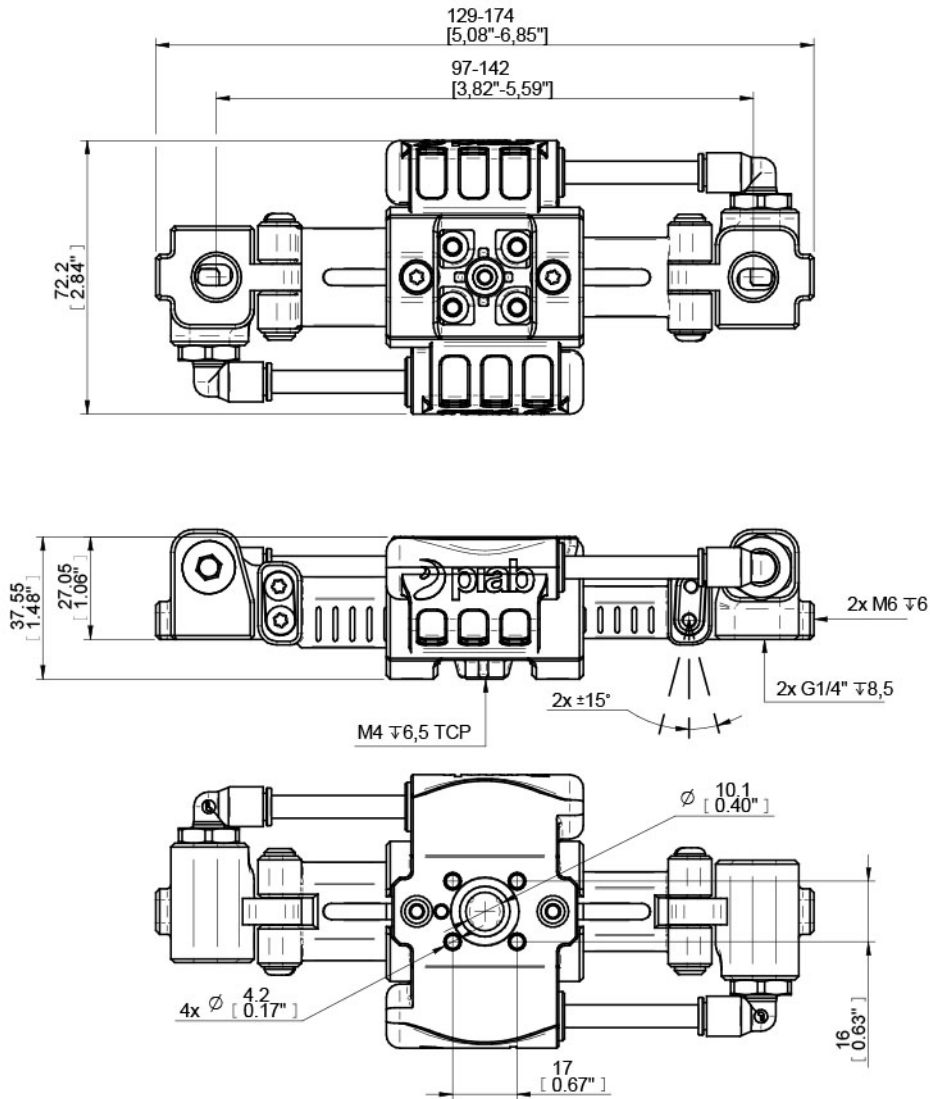

## ORDERING INFORMATION

Description	Code
piCOBOT® Universal Robots, ISO 9409-1-50 – 4 – M6, Extra high vacuum flow (micro), MICRO (14-19 NI/min), Double, Standard input/output, ES Automatic level determination (ALD), Intelligent Blow-Off (IBO), Self adhesion control (SAC), [-kPa], Analog and digital output, No vacuum filter, ø6 push-in angle connector, NC vacuum + NC Blow-Off, UR specific, Cable M8-8p male/M8-8p fem, Adjustable gripper, 2xG1/4", piSAVE sense 03/60, C. flow 0,37 NI/s, No suction cup	PCO.U1.M01.T.MC2.S221PA.X.6.CC.A.A03X

**BIBUS®**  
SUPPORTING YOUR SUCCESS

BIBUS SK, s.r.o  
Trnavská 31, SK-94 901 Nitra

Tel.: 037/ 7777 911 Email: sale@bibus.sk  
Fax.: 037/ 7777 999 http://www.bibus.sk